

stern

STERN ENGINEERING LTD.



TOP FILLING MULTIFEED KIT

FOR MULTIPLE SOAP DISPENSER INSTALLATION

INSTALLATION AND MAINTENANCE GUIDE

INDEX

1-3	TECHNICAL DATA
4 -5	PACK CONTENTS
6	PRE-INSTALLATION INFORMATION
7-11	INSTALLATION
12	FILLING THE SOAP TANK
13	SETTINGS ADJUSTMENT
14	BATTERY REPLACEMENT INSTRUCTIONS
14	MAINTENANCE
15	TROUBLE SHOOTING
16	WARRANTY
17	SPARE PARTS LIST

TECHNICAL DATA

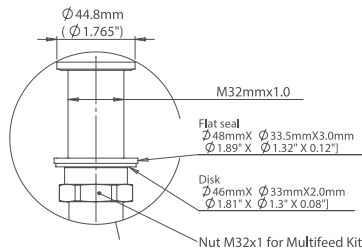

Capacity: 5 Liters \ 169 oz

Power Supply: 12 V Transformer

Soap viscosity: 100 – 3000 cPs

RECOMMENDED HOLE SIZE:

Top filling kit: Min: $\varnothing 32.5\text{ mm}$ (1.280")

Max: $\varnothing 35.2\text{ mm}$ (1.385")

MF deck mounted soap dispenser: Min: $\varnothing 26\text{ mm}$ (1.024")

Max: $\varnothing 30\text{ mm}$ (1.181")

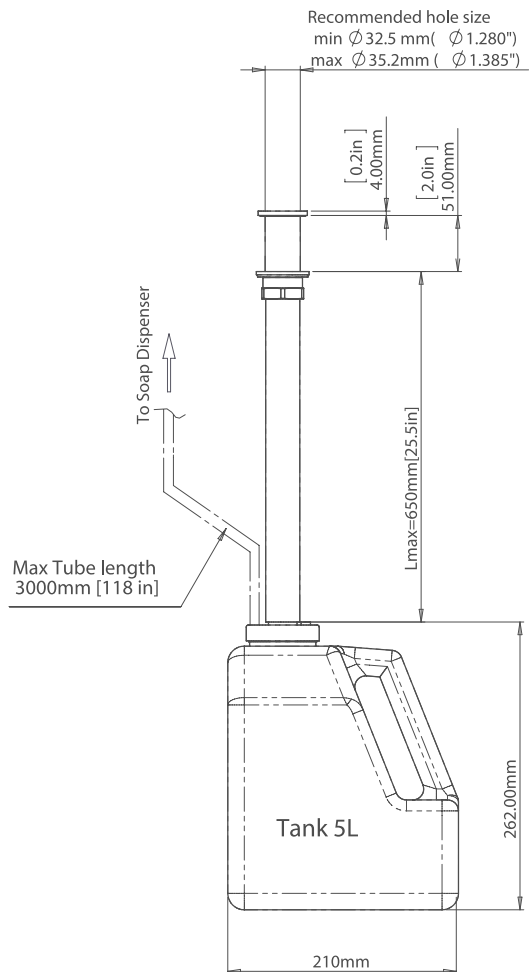

TOP FILLING MULTIFEED KIT 07220090

TECHNICAL DATA

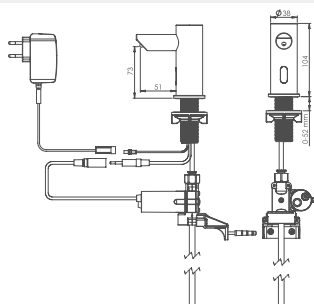

MF SMART SOAP DISPENSER
07292055

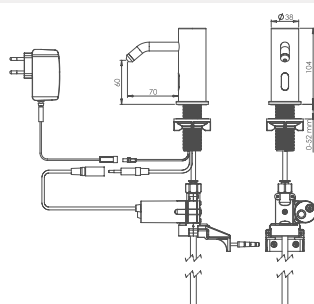

MF EXTREME SOAP DISPENSER
07292056

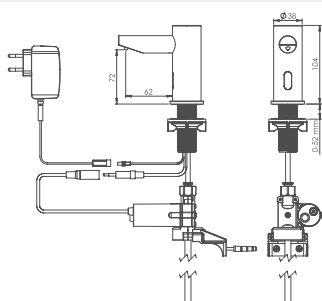

MF TRENDY SOAP DISPENSER
07292073

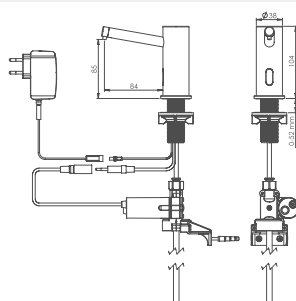

MF ELITE SOAP DISPENSER
07292077

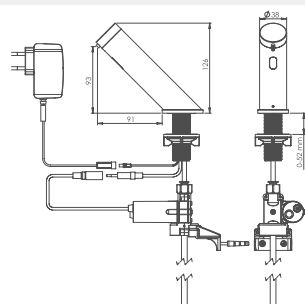

MF GREEN SOAP DISPENSER
07292062

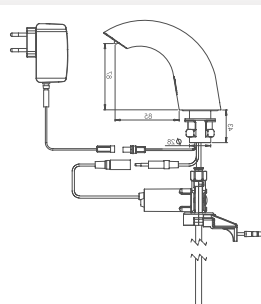

MF SWAN SOAP DISPENSER
07292117

TECHNICAL DATA

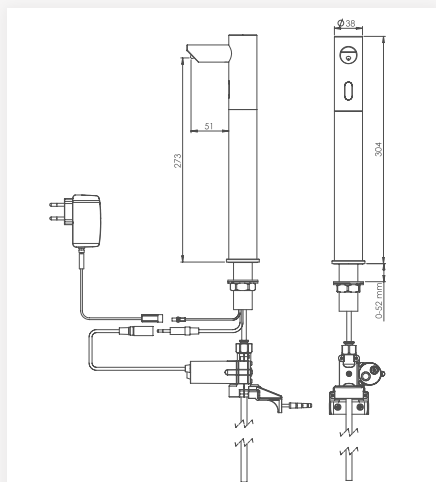

MF SMART SOAP DISPENSER PLUS
07292118

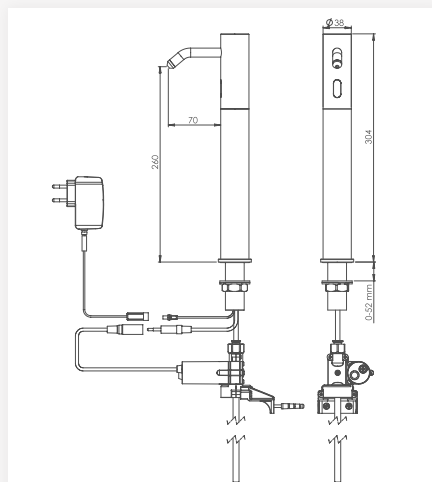

MF EXTREME SOAP DISPENSER PLUS
07292056

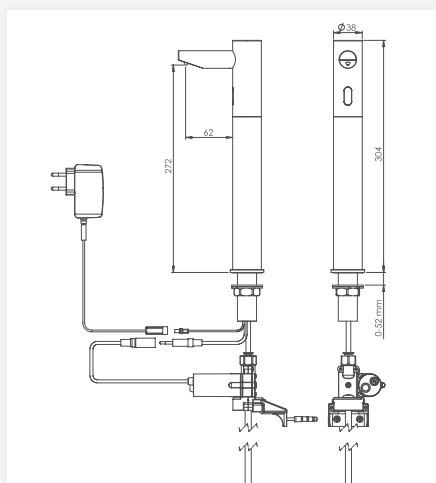

MF TRENDY SOAP DISPENSER PLUS
07292073

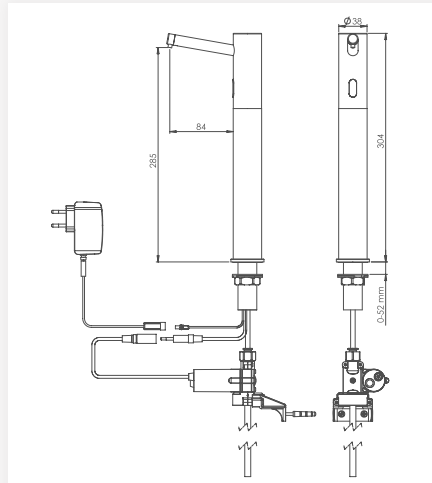

MF ELITE SOAP DISPENSER PLUS
07292077

PACK CONTENTS

TOP FILLING MULTIFEED KIT

Familiarize yourself with the part names and confirm that the parts are included.

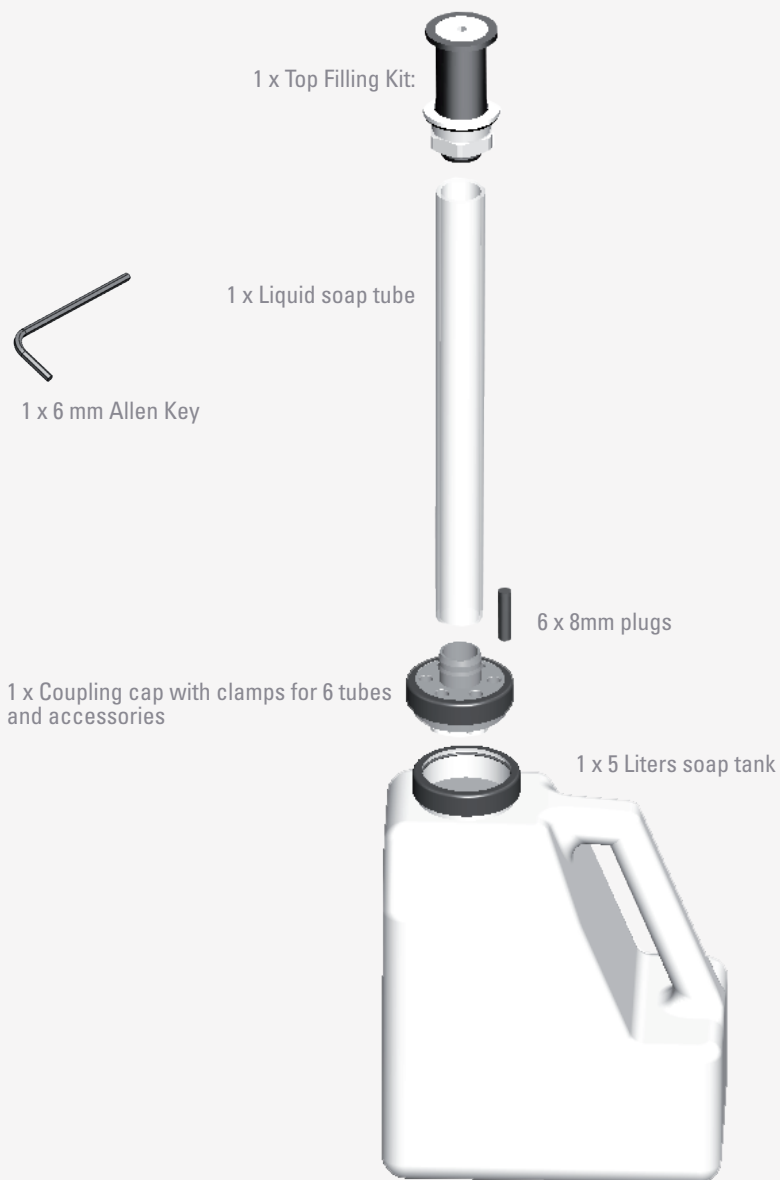

PACK CONTENTS

MF SOAP DISPENSERS

Familiarize yourself with the part names and confirm that the parts are included.

1. 1 x Body and fixing accessories

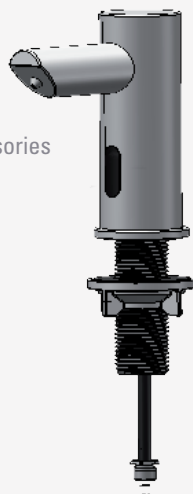

2. 1 x MF pump assembly with pump support and 3m pipe

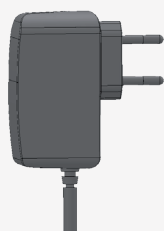

12V
Transformer

PRE-INSTALLATION INFO

CHECK CONTENTS

Separate all parts from the packaging and check each part with the “pack contents” section.

Make sure all parts are accounted for before discarding any packaging material.

If any parts are missing, do not attempt to install the system until you obtain the missing parts.

IMPORTANT

Pay attention to the recommended hole size of the Top Multifeed cap as advised in the ‘technical data’ section.

Keep in mind that the location of the user hands, while using the faucet nearby should not interfere with the soap dispenser sensor detection area.

WARNINGS

Do not install the soap dispensers facing a mirror or any other electronic system operated by an infra-red sensor.

To prevent reflection problems, it is recommended to keep a minimum distance of 1.50 meters between the soap dispensers and any other objects.

INSTALLATION

STEP 1 – INSTALLING THE MF SOAP DISPENSER/S

1

Drill a hole in the deck or lavatory according to the MF soap dispensers recommended hole size specified in the 'Technical Data' section of this manual.

Remove the nut, the disk and the gasket from the base of the MF soap dispenser body.

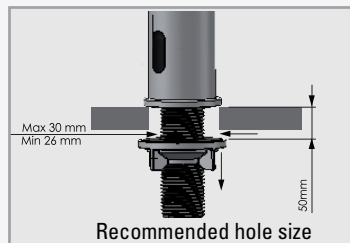

2

Place the soap dispenser body along with the bottom ring into the hole in the deck or lavatory and slide the gasket, disk and nut over the soap dispenser body nipple and secure it.

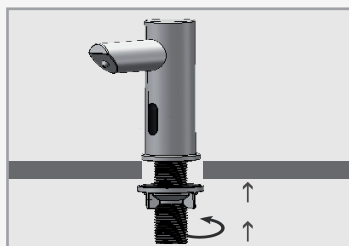

3

Assemble the tube from the pump to the soap dispenser body and screw in the nut.

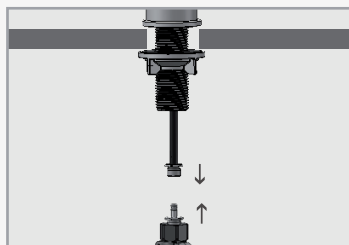

4

Fix the pump to the desired location by securing the support with the supplied screws.

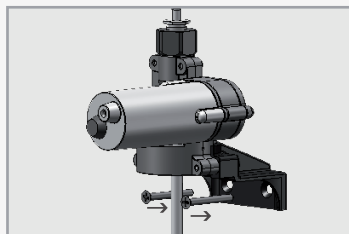

INSTALLATION

STEP 2 – INSTALLING THE TOP MULTIFEED KIT

1

Drill a hole in the deck or lavatory according to the top filling kit recommended hole size specified in the 'Technical Data' section of this manual.

Remove the flat seal, disk and nut from the base of the top filling kit.

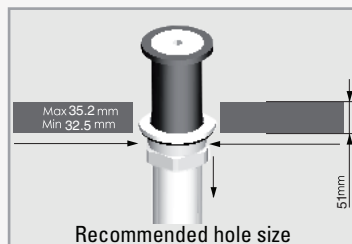

2

Place the top filling kit into the hole in the deck or lavatory and secure it in place using the flat seal, disk and nut.

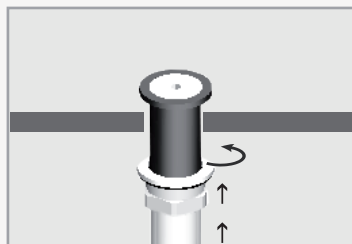

3

If you are using the soap tank support, fix it to the desired location.

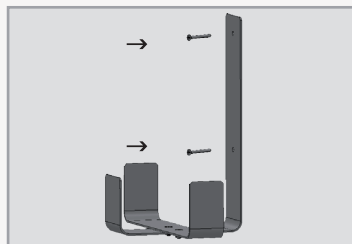

4

Place the soap tank under the deck or within the tank support.

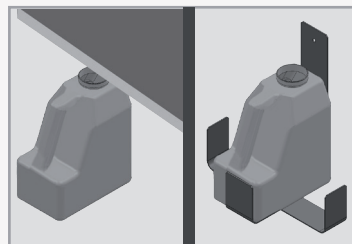

INSTALLATION

5

Cut the soap intake tube to the right length as required by the installation.

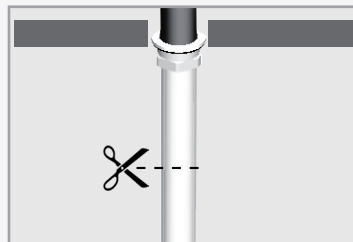

6

Connect the soap intake tube to the soap tank.

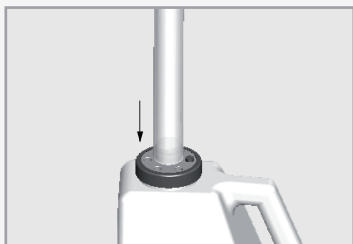

7

Cut the soap pipes coming from the MF soap dispenser to the right length as required by the installation.

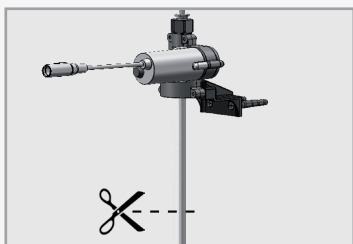

Make sure the end of the pipes is about 20 mm longer than the tank inner base.

8

Connect the MF soap dispensers' pipes to the holes in the soap tank cap.

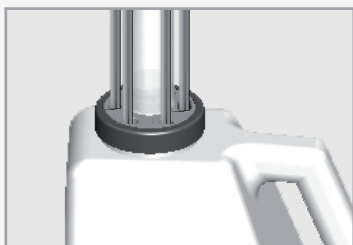

NOTE: The Top filling Multifeed Kit enables installing up to 6 soap dispensers simultaneously. When installing less than 6 soap dispensers, make sure to plug the remaining holes with the provided 8mm plugs.

INSTALLATION

STEP 3 - CONNECTING THE POWER SOURCE

1

Remove the protective sticker covering the sensor. Keep away from the sensor range.

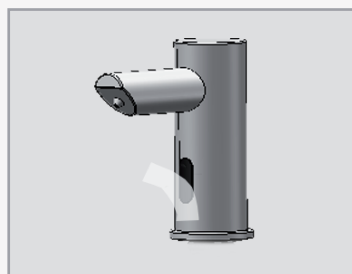

2

a. Connect the motor connector to the power source connector. Please note that since the connector is water proof, some friction might apply.

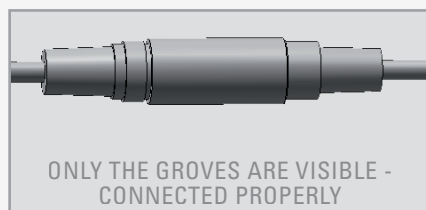
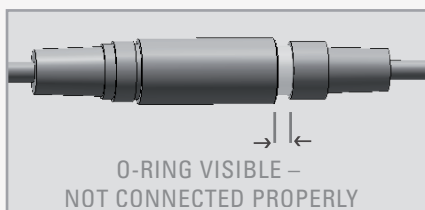

Important: the 4 contacts connector should be connected properly so that the white o-ring is not visible and a clicking sound is heard.

Pay attention: If the 4 contacts connectors will not be connected properly, the motor will work continuously.

INSTALLATION

STEP 3 - CONNECTING THE POWER SOURCE

2

b. Plug the transformer into the electricity socket and connect the transformer connector

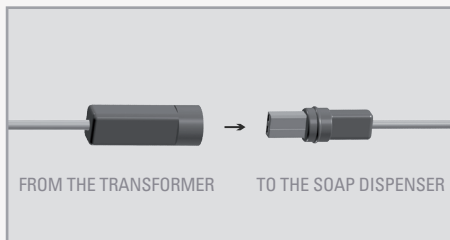

3

Wait about 10 seconds before you put your hands within the sensor range.



FILLING THE SOAP TANK

STEP 1 – FILLING THE SOAP TANK

1

Open the top filling cap using the 6mm Allen key provided.



2

Fill the soap tank with liquid soap until it is full. Refer to the 'Technical Data' section of this manual for soap viscosity specifications.

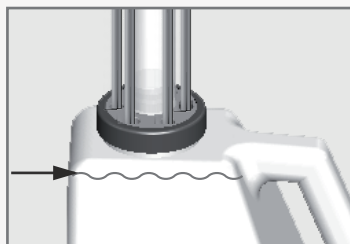

STEP 2 – BRINGING THE SOAP TO THE MF SOAP DISPENSERS' SPOUT

1

Press the fill function in the soap dispenser remote control as described in the 'Setting adjustment' section of this manual.



2

Alternatively, press the fill button located at the back of the MF soap dispenser pump assembly until soap starts coming out of the spout.

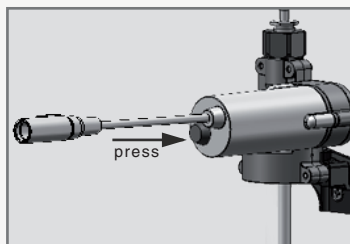

SETTINGS ADJUSTMENT

If desired, use the remote control to adjust the soap dispenser settings. Hold the remote control straight in front of the sensor in a distance of about 4-6" (10-15cm).

Attention: Holding the soap dispenser remote control out of the recommended range (too close or too far) may interfere with the remote's activation.

Choose the function you want to adjust by pressing on the function button as following:

1-SOAP QUANTITY

The 1-4 drop keys allow the user to choose the desired soap quantity.

① 0.2 to 0.4

② 0.7 to 0.9

③ 1.2 to 1.6

④ 2.1 to 2.3 *

Indication: continues blink of the red light in the sensor eye.

* The exact soap dosage depends on the soap viscosity.

2-ADJ

This function allows coming back to soap quantity factory settings.

Indication: 2 blinks of the red light in the sensor eye.

3-TEMPORARY OFF FUNCTION

This function is ideal to perform any kind of activity in front of the sensor without operating the system (for example, cleaning). The soap dispenser will remain shut for one minute when this button is pressed once.

To cancel this function and to return to normal operation press the On/Off button again or wait one minute.

Indication: OFF – 2 fast blinks, ON – 4 fast blinks

4-FILL THE SOAP TANK

Once the soap tank has been filled \ re-filled, press the FILL button. The pump would work for one minute in order for the soap to start coming out of the soap dispenser spout.

To stop this activity press the FILL button again. If the soap has not started coming out of the spout, press the Fill button again.



MAINTENANCE

Care and cleaning of chrome and special finishes

DO NOT use steel wool or cleansing agents containing alcohol, acid, abrasives, or the like. Use of any prohibited cleaning or maintenance products or substances could damage the surface of the soap dispenser. For surface cleaning use ONLY soap and water, then wipe dry with a clean cloth or towel. When cleaning bathroom tiles, the soap dispenser should be protected from any splattering of harsh cleansers.

TROUBLE SHOOTING

PROBLEM	INDICATOR	CAUSE	SOLUTION
SOAP QUANTITY DIMINISHED		Battery is running low	Replace Battery
NO SOAP COMING OUT OF THE SPOUT	Red light in the sensor flashes continuously when the user's hands are within the sensor's range.	Low battery.	Replace battery.
	Soap has run low or completely out.	Soap has run low or completely out.	Refer to page 4 and refill the soap tank.
		The soap tank has been filled but soap has not reached the spout.	Press the refill button located at the bottom of the pump until soap starts to come out of the spout again.
		The connectors between the motor and the power source are not connected properly.	Connect the connectors properly so that the white o-ring is not visible. Refer to page 7 to see how.
	Red light in the sensor does not flash (once) when user's hands are within the sensor's range.	Sensor is picking up reflections from the washbasin or another object.	Eliminate cause of reflection.
		Connectors between the electronic unit and the pump assembly \ transformer are disconnected or not properly connected.	Connect the electronic unit connectors to the pump assembly and transformer.
		Battery is completely used up.	Fill the bottle with hot water at 50/60C and run the pump constantly.
SOAP COMING OUT FROM THE SPOUT DOES NOT STOP	Red light flashes (once) and the motor operates.	Soap solidification at the pipe.	Fill the bottle with hot water at 50/60C and run the pump constantly.
		The black connectors between the pump assembly and soap dispenser are not connected properly.	Connect the connectors properly so that the white o-ring is not visible. Refer to page 7 to see how.

WARRANTY

Y. Stern Engineering Ltd. warrants that its electronic products will be free of defects in material and workmanship during normal use for two years from the date the product is purchased.

If a defect is found in normal use, Y. Stern Engineering Ltd. will, at its discretion, repair, provide a replacement part or product, or make appropriate adjustments. Damage caused by accident, misuse, or abuse is not covered by this warranty. Improper care and cleaning will void the warranty. Proof of purchase (original sales receipt) must be provided to Stern Engineering Ltd. with all warranty claims.

Stern Engineering Ltd is not responsible for labor charges, installation, or other incidental or consequential costs other than those noted above. In no event shall the liability of Stern Engineering Ltd. exceed the purchase price of the product.

If you believe that you have a warranty claim, contact your Stern Distributor, Dealer or Plumbing Contractor. Please be sure to provide all pertinent information regarding your claim, including a complete description of the problem, the product, model number, the date the product was purchased, from whom the product was purchased and the installation date. Also include your original invoice.

Y. STERN ENGINEERING AND/OR SELLER DISCLAIM ANY LIABILITY FOR SPECIAL, INCIDENTAL OR CONSEQUENTIAL DAMAGES. This warranty excludes product damage due to installation error, incorrect maintenance, wear and tear, battery, product abuse, or product misuse, whether performed by a contractor, service company, or the consumer. This warranty does not cover product damage caused by the following:

- Incorrect installation.
- Improper manipulation, tampering, bad or lapsed maintenance.

SPARE PARTS LIST

Top Multifeed Cap Kit.....	07270214
8Mm Transparent Tube	07300024
Seals And Screws Kit	07210146
Soap Filling Kit.....	07260032
Coupling cap for 6 tubes and accessories	07260033
Soap Tank 5L.....	07100023
5 litters Tank support	07055223
Pump Assembly	07246020
Input Plug Kit	07260034
MF soap dispenser Sensor kit Green.....	08002236
MF soap dispenser Sensor kit Smart, Extreme,Trendy,Elite,Swan	07220072
MF soap dispenser Sensor kit Tubular, Quadrat.....	08002195
12V Transformer EU plug	06522081
12V Transformer Universal/UK plug	06522082
12V Transformer US plug.....	06522080
Remote control for soap dispensers.....	07100008

stern

STERN ENGINEERING LTD.

15 Gan Rave Blvd., 81222 Gan Rave, Yavne, Israel

Tel: 972-8-9326000, Fax: 972-8-9326025, export@sternfaucets.com

www.sternfaucets.com

